

Joto 5 in 1 MugPress Manual

Model No.: E-HP-JMP-51

OPERATOR'S MANUAL



JOTOTM
Bringing images to lifeTM

Safety Instructions

For Use By Qualified Personnel Only

When using your Mug Press, basic precautions should always be followed, including the following:

Read all instructions.

Use mug press only for its intended use.

Keep the mug press dry at all times. Do not get the mug press wet to reduce the risk of electric shock. Do not store mug press in a wet or damp area.

Never pull cord to disconnect the power, grasp plug and pull to disconnect from power outlet.

Protect the power cord by keeping it away from hot surfaces. Do not allow objects to sit on top of the cord. This could cause damage to the cord and could become a fire hazard risk.

Do not operate mug press with a damaged cord or if the equipment has been damaged. Do not disassemble or attempt to repair the mug press to prevent risks to injury. Call or take it to a qualified service person for examination and repair. Incorrect assembly or repair could increase the risk of fire, electric shock, or injury to persons when the equipment is used.

Supervision is necessary for any mug press being used by or near children. Do not leave equipment unattended while connected.

Metal parts on the press can become hot. Burns may occur when touching hot metal parts. Take caution when using the mug press

To reduce the likelihood of circuit overload, It is recommended to use a dedicated circuit if possible.

Care should be taken to arrange the cord so that it cannot be pulled or tripped over.

To reduce the likelihood of circuit overload, do not operate other high voltage equipment on the same circuit.

If an extension cord is necessary, then a 20 amperage rated cord should be used. Cords rated for less amperage may overheat. Care should be taken to arrange the cord so that it cannot be pulled or tripped over.

Note: Temperature is in Celsius. This mug press should not be set to exceed 200C. Setting the press temperature to above 200C will burn out your mug element and may cause a fire hazard.

Do not use any other power cords other than the one provided with this machine. Doing so may result in a fire hazard. If you need a replacement cord, please call Joto to request one.

Congratulations on your purchase of a Joto 5 in 1 Mug Press! In order to work professionally with the machine and start production, please make sure you read this manual carefully. Reproduction of this manual requires written consent from Joto. Errors and amendments of technical details excepted, all rights reserved. Joto is not liable for any direct or indirect damages caused by the use of this product.

Table of Contents

Safety.....	2
Introduction	3
Machine Parts Diagram	4
Setting Up Your Mug Press.....	5
Operating Instructions	6
Mug Press Overview	7
Maintenance	8
Joto Sublimation Guide	8
Replacing The Mug Element	9
Circuit Diagram.....	10
Expanded View	11
Contact	12

Machine Parts Diagram

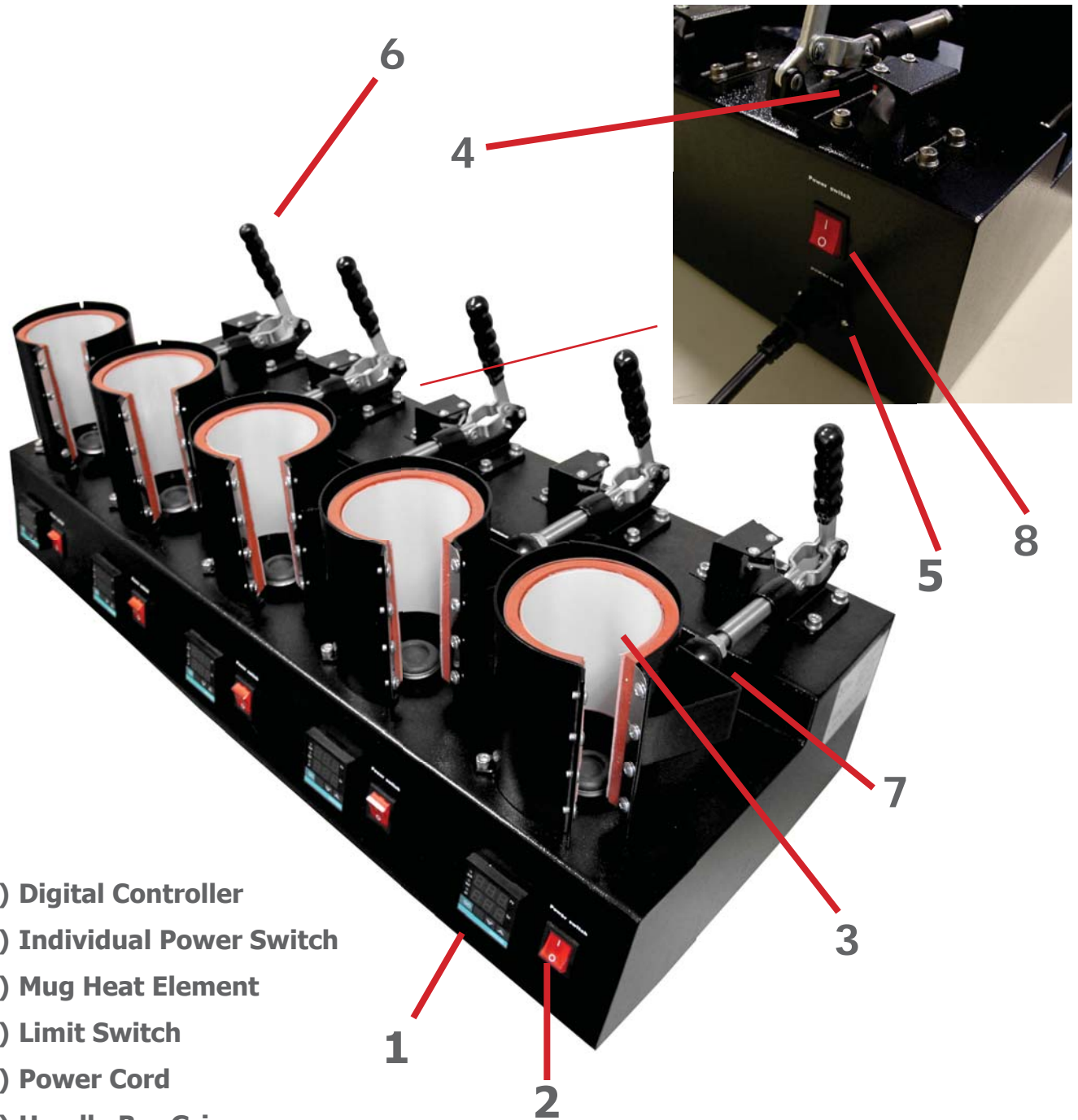

- 1.) Digital Controller
- 2.) Individual Power Switch
- 3.) Mug Heat Element
- 4.) Limit Switch
- 5.) Power Cord
- 6.) Handle Bar Grip
- 7.) Pressure Adjustment Knob
- 8.) Main Power Switch

Setting Up Your Mug Press

Turning On Your Mug Press

- 1.) Turn the Main Power Switch on. The Main Power Switch is at the back of the mug press.
- 2.) Turn Individual Mug Elements on. Note - To conserve power and to prolong mug element life, only turn on the elements you need to use.

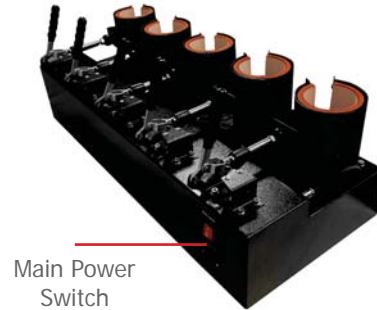

How to Read The Display

PV value = Current Temperature

SV value = Press Time

Each Mug element will need to be set separately



Setting Press Temperature

- 1.) With the power on, press and hold the up arrow for 2 second
 - 2.) PV value changes to "SP"
 - 3.) Use the up and down arrows to set your Press Temperature.
- Note: Temperature is in °C
- 4.) When done setting temperature, press the set button to save.

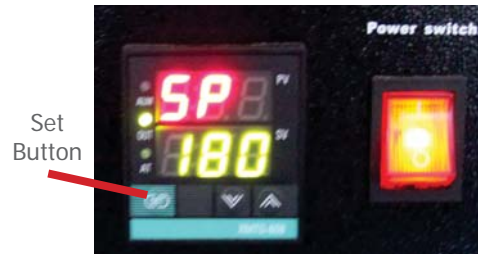

Note: Temperature is in Celsius. This mug press should not be set to exceed 200C. Setting the press temperature to above 200C will burn out your mug element and may cause a fire hazard.

Setting Press Time

- 1.) With the power on, press and hold the down arrow for 2 seconds
- 2.) PV value changes "EE"
- 3.) Use the up and down arrows to set the Press Time
- 4.) When done setting time, press the set button to save.

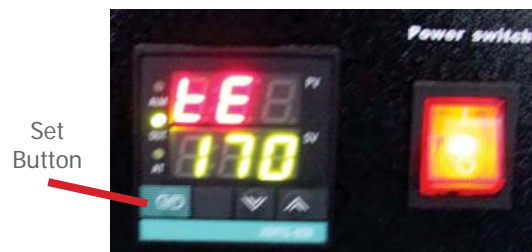

Operating Process

Pressing a Mug

- 1.) Turn on the Main Power Switch
- 2.) Turn on the individual power switches for the mug elements you wish to use
- 3.) Set the appropriate Press Temperature, and Time.
- 4.) Tape your imaged transfer/sublimation paper to your mug with heat tape.
- 5.) Set the pressure. To do this, place a blank mug into the mug element. Adjust the pressure knob until the mug fits snugly in the element (just enough pressure so that the mug cannot be moved once press is closed).
Turn pressure knob counter-clockwise to tighten and clockwise to loosen.
- 6.) Wait until current temperature is the same as set temperature. Once the mug press is at temperature, place mug into the press. Close the mug press.
- 7.) Timer will start counting down. The press will beep when the set time has lapsed. When mug press beeps, open mug press and take out mug.
Note: Ensure the timer starts immediately after closing the press. If it does not, take the bottle out & wait for the temperature to go up to the set temp.
- 8a.) For sublimation, peel immediately and dunk into warm-cold water
- 8b.) For Hard Surface Papers, Dunk in warm water-cold water. Then wait until the mug is cold before peeling.

Pressing a Water bottle

- 1.) Turn on the Main Power Switch
- 2.) Turn on the individual power switches for the mug elements you wish to use
- 3.) Set the appropriate Press Temperature, and Time.
- 4.) Tape your imaged transfer/sublimation paper to your mug with heat tape.
- 5.) Place the green heat shield in your press.
- 6.) Set the pressure. To do this, place a blank water bottle into the mug element. Adjust the pressure knob until the bottle fits snugly in the element with the heat shield wrapped around the bottle (just enough pressure so that the bottle and heat shield cannot be moved once press is closed).
Turn pressure knob counter-clockwise to tighten and clockwise to loosen.
- 7.) Wait until current temperature is the same as set temperature. Once the mug press is at temperature, place mug into the press. Close the mug press.
Note: Ensure the timer starts immediately after closing the press. If it does not, take the bottle out & wait for the temperature to go up to the set temp.
- 8.) Timer will start counting down. The press will beep when the set time has lapsed. When mug press beeps, open mug press and take out mug.
- 9a.) For sublimation, peel immediately and dunk into warm-cold water
- 9b.) For Hard Surface Papers, Dunk in warm water-cold water. Then wait until the mug is cold before peeling.

Mug Press Overview



Technical Specs

1. Model No.: MPA-500B - (5 Individual Digital Temps & 5 Timers)
2. Machine Dimension: 820 x 365 x 285mm
3. Dia.7.5-9.0cm for 11oz,15oz etc Mug
4. Printable Articles Max Size: $\phi 100 \times 120$ mm
5. Voltage: 220V/1Phase; 110V/1Phase
6. Power: 1.5KW
7. Recommend Setting: 30~280s; 180~200°C
Time Range: 0~450s
Maximum Temp: 200 C°
8. Packing Size: 93*45*37cm
9. Gross Weight: 29kg

Note: Temperature is in Celsius. This mug press should not be set to exceed 200C. Setting the press temperature to above 200C will burn out your mug element and may cause a fire hazard.

Maintenance

General Maintenance

Please switch off the machine and unplug the power cord when the machine is not in use.

To prolong the life of the heat elements and to conserve power, please turn off any individual mug elements not in use.

Mug elements will wear out over time. When they wear out, you will need to replace them with new ones. The rated life expectancy of an mug element is approximately 1000-2000 mugs. Elements may wear out earlier due to other factors:

- 1.) No mug is in the press when on and the press is closed
- 2.) Physical abuse
- 3.) Environmental factors

2) The mug element will start to cool down to room temperature, if heat press stays un-use for more than 30 minutes.

Note: Temperature is in Celsius. This mug press should not be set to exceed 200C. Setting the press temperature to above 200C will burn out your mug element and may cause a fire hazard.

Mug Pressing Guide

11oz Mugs

Temperature: 180C
Time: 150-180 seconds

20oz Glass Beer Mug

Temperature: 180C
Time: 240 seconds

Aluminum Water Bottles

Temperature: 160C
Time: 120-140 seconds

15oz Mugs

Temperature: 180C
Time: 150-180 seconds

16oz Frosted Beer Mug

Temperature: 180C
Time: 240 seconds

Stainless Steel Water Bottles

Temperature: 160C
Time: 120-140 seconds

Replacing The Mug Element

Replacing your Mug Element

- 1.) Ensure both the individual power switch and the main power switch is off
- 2.) Unplug the mug press if it is still plugged in.
- 3.) Detach the mug element cord from the mug press. Unscrew the ring that holds the cord in place before detaching. See below diagram for detailed instructions
- 4.) With the Mug Press open, unscrew the six screws that hold the mug element in place.
- 5.) Gently slide the mug element out of the mug press. Please be careful not to damage the cord or the mug press.
- 6.) Gently slide the new mug element into the mug press
- 7.) Re-screw the 6 screws to keep the mug element from moving
- 8.) Connect the new mug element cord to the mug press.
Ensure that the pattern on the cord matches the socket on the mug press.

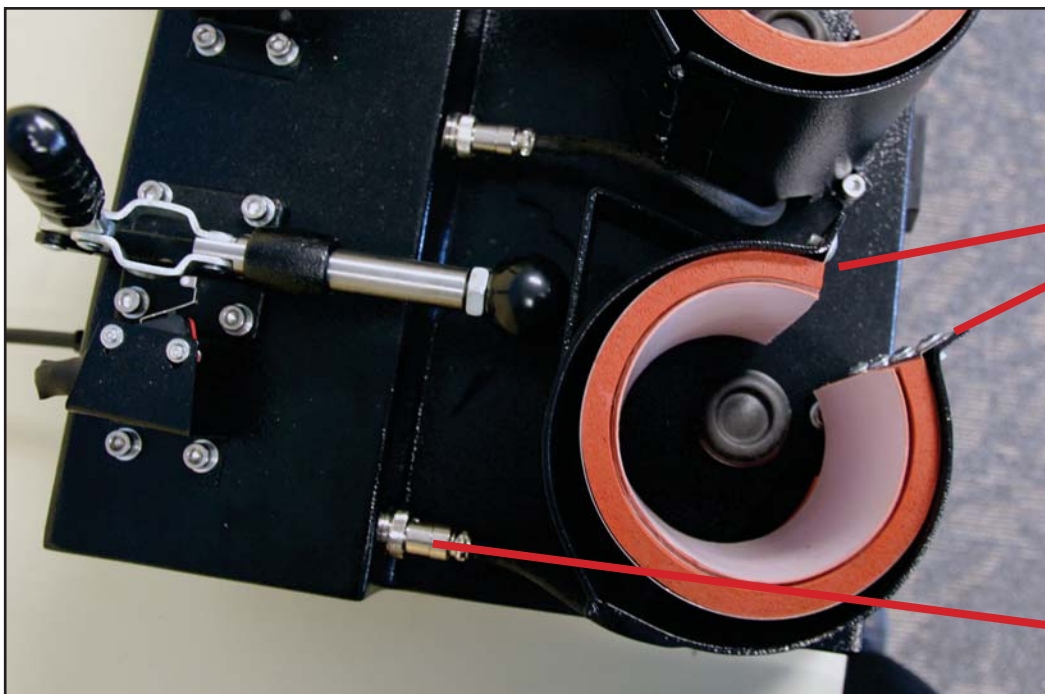

6 screws that hold mug element in place

Mug Element Cord and ring

Circuit Diagram

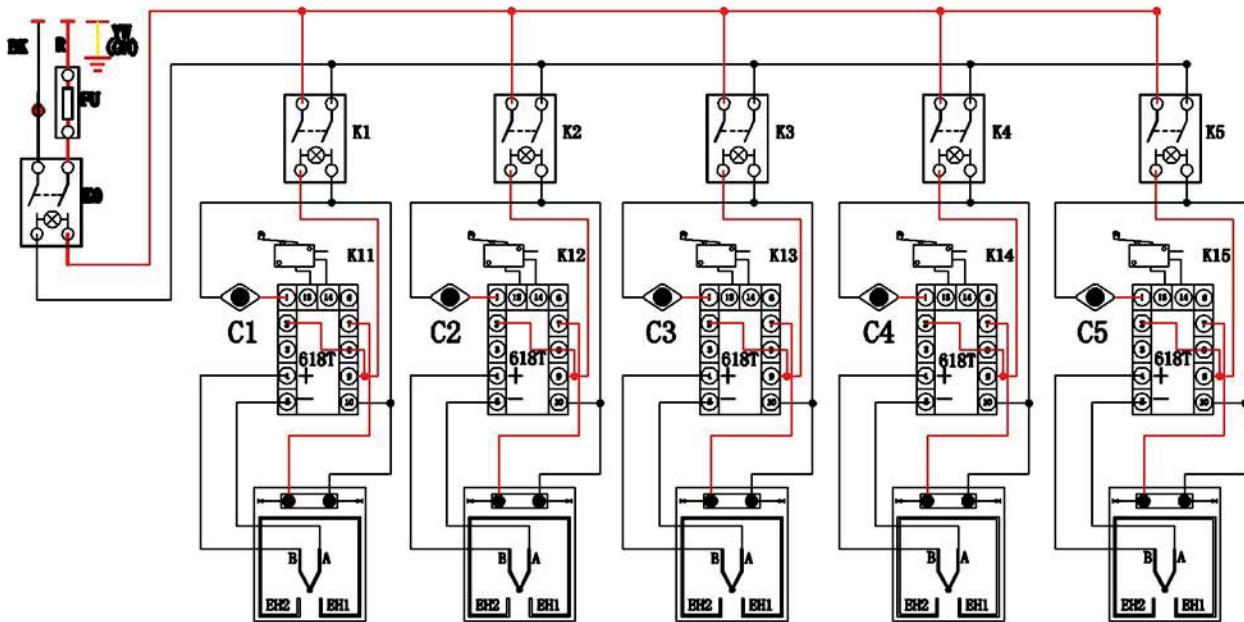

K₀: Power Switch

K₁₁-K₁₅: Individual Limit

FU:Fuse

EH₁,EH₂:Heating Pipe

K₁-K₅: Individual Power Switch

C₁-C₅: Buzzer

A(B): Thermocouple

618T: Digital Controller

Expanded Diagram

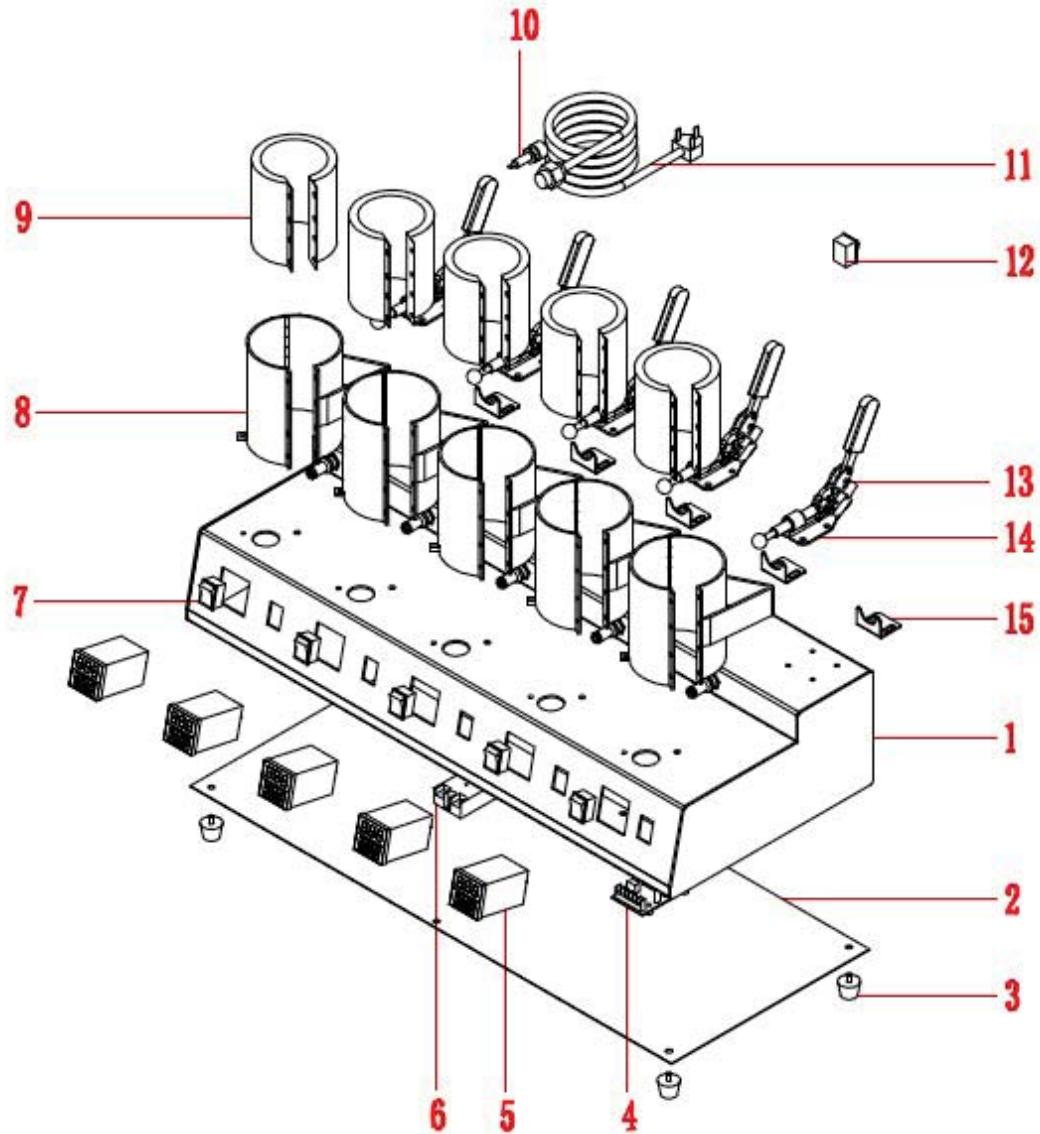

Serial No.	Part Name	Qty
1	Machine Body	1
2	Cover Plate	1
3	Rubber Foot	4
4	Transformer	1
5	Digital Controller	1
6	Solid State Relay	1
7	Power Switch	5
8	Heater Installation Holder	5

9	Mug Heater	5
10	Fuse	1
11	Power Cord	1
12	Main Power Switch	1
13	Micro Switch	1
14	Speeding Clip	5
15	Clip Position Limiter	5

JOTOTM

A red swoosh underline that starts under the 'J' and extends to the right, ending under the 'O'.

Bringing images to lifeTM

www.jotopaper.com

Tel: 1-800-565-5686

Fax: 1-800-565-55622

**Coquitlam, BC | Mississauga, ON
Blaine, WA | Las Vegas, NV | Nashville TN**