

# Joto Shuttle Press Manual

Model No.: E-HP-JSP-1620

OPERATOR'S MANUAL

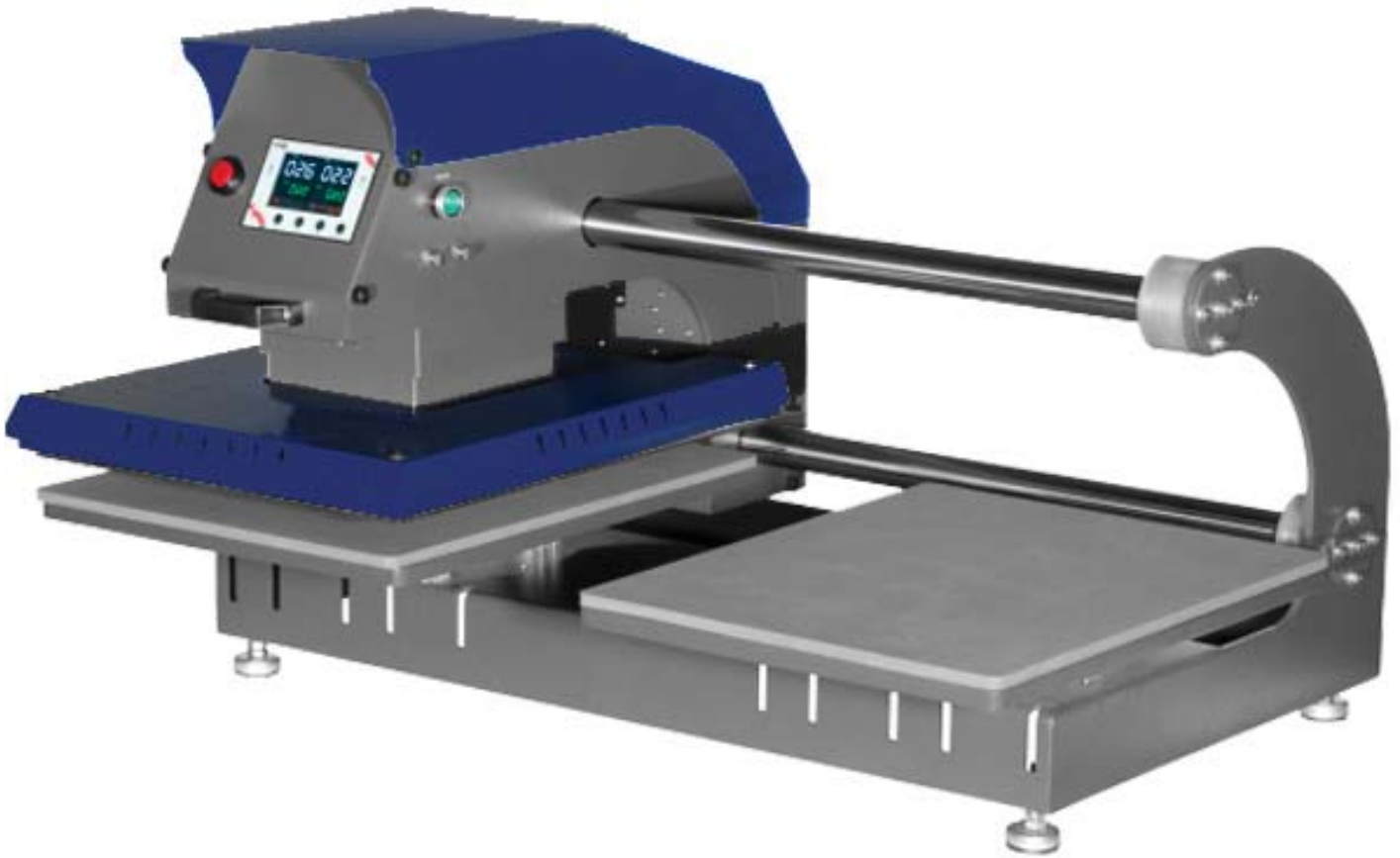

**JOTO**<sup>TM</sup>  
Bringing images to life<sup>TM</sup>

# Safety Instructions

## For Use By Qualified Personnel Only

When using your Heat Press, basic precautions should always be followed, including the following:

Read all instructions.

Use heat press only for its intended use.

Keep the heat press dry at all times. Do not get the heat press wet to reduce the risk of electric shock. Do not store heat press in a wet or damp area.

Never pull cord to disconnect the power, grasp plug and pull to disconnect from power outlet.

Protect the power cord by keeping it away from hot surfaces. Do not allow objects to sit on top of the cord. This could cause damage to the cord and could become a fire hazard risk.

Do not operate heat press with a damaged cord or if the equipment has been damaged. Do not disassemble or attempt to repair the heat press to prevent risks to injury. Call or take it to a qualified service person for examination and repair. Incorrect assembly or repair could increase the risk of fire, electric shock, or injury to persons when the equipment is used.

Supervision is necessary for any heat press being used by or near children. Do not leave equipment unattended while connected.

Metal parts on the press can become hot. Burns may occur when touching hot metal parts. Take caution when using the heat press

To reduce the likelihood of circuit overload, It is recommended to use a dedicated circuit if possible.

Care should be taken to arrange the cord so that it cannot be pulled or tripped over.

To reduce the likelihood of circuit overload, do not operate other high voltage equipment on the same circuit.

If an extension cord is necessary, then a 20 amperage rated cord should be used. Cords rated for less amperage may overheat. Care should be taken to arrange the cord so that it cannot be pulled or tripped over.

**Note: This heat press should not be set to exceed 200C. Setting the press temperature to above 200C may cause a fire hazard.**

**Congratulations on your purchase of a Joto Shuttle Heat Press! In order to work professionally with the machine and start production, please make sure you read this manual carefully. Reproduction of this manual requires written consent from Joto. Errors and amendments of technical details excepted, all rights reserved. Joto is not liable for any direct or indirect damages caused by the use of this product.**

## **Table of Contents**

<b>Safety.....</b>	<b>2</b>
<b>Introduction .....</b>	<b>3</b>
<b>Machine Parts Diagram .....</b>	<b>4</b>
<b>Setting Up Your Heat Press .....</b>	<b>5</b>
<b>Operating Instructions .....</b>	<b>6</b>
<b>Heat Press Overview .....</b>	<b>7</b>
<b>Maintenance .....</b>	<b>8</b>
<b>Joto Sublimation/Transfer Vinyl Guide ....</b>	<b>8</b>
<b>Circuit Diagram.....</b>	<b>10</b>
<b>Expanded View .....</b>	<b>11</b>
<b>Contact .....</b>	<b>12</b>

# Machine Parts Diagram

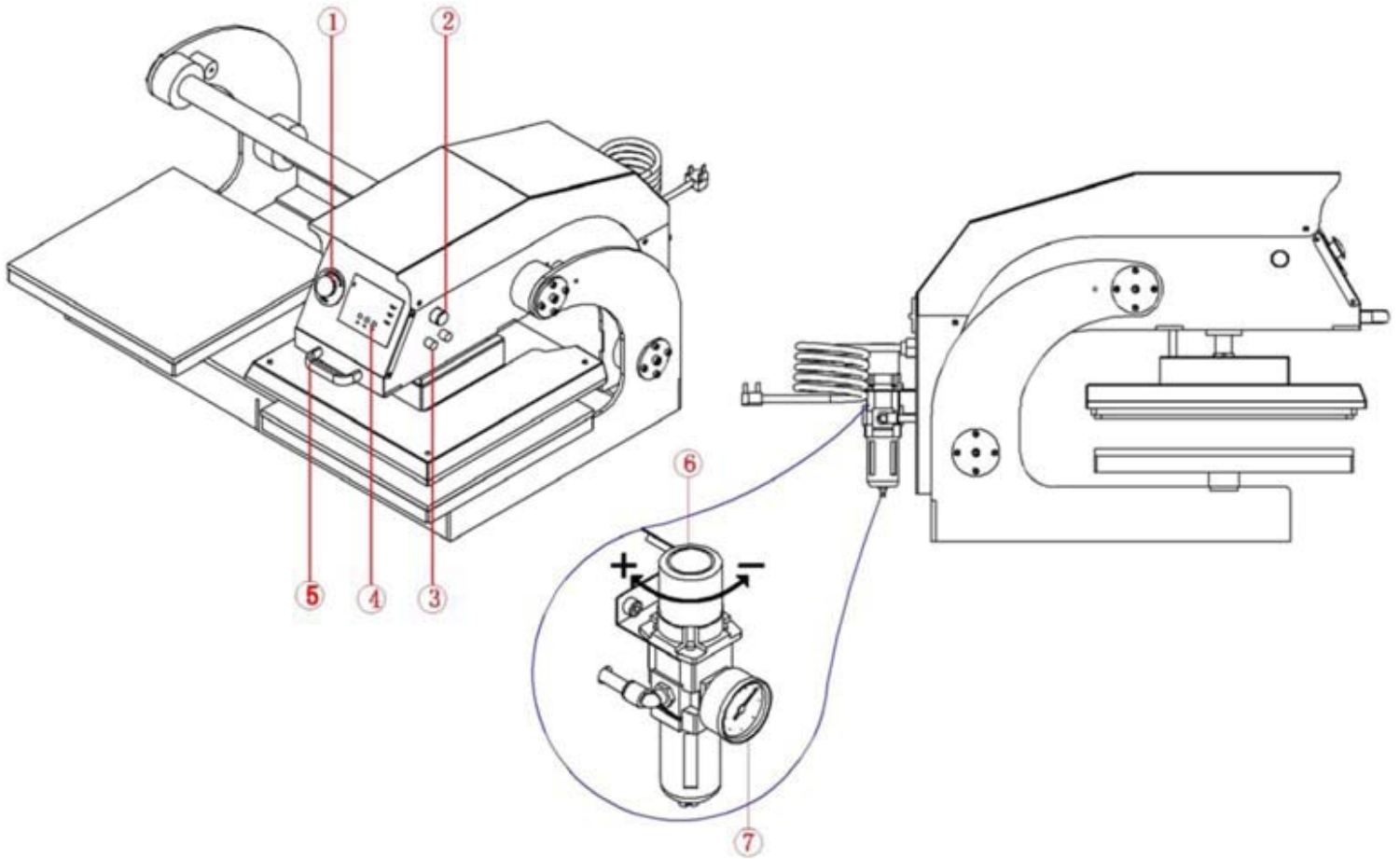

- 1.) Emergency Stop Button
- 2.) Start Switch
- 3.) Air Pressure Adjust Knob
- 4.) GY-06 Controller
- 5.) Shuttle Handle
- 6.) Pneumatic Valve
- 7.) Air Filter

# Setting Up Your Heat Press

## Turning On Your Heat Press

Turn the Main Power Switch on. The Main Power Switch is at the back of the heat press.

Current temperature, set temperature, current time, set time will display.



## How to Read The Display

- 1.) Left side PV value = Current Temperature
- 2.) Right side PV value = Current Time
- 3.) Left side SV value = Set Press Temperature
- 4.) Right side SV value = Set Press Time



## Setting Press Temperature

Press OK to start. Use the up and down arrows to choose to display in °F or °C.

°F stands for Fahrenheit

°C stands for Celsius

Once selection is made, press ok to save

Green set temperature value will flash.

Use the up and down arrows to set press temperature value. Press ok to save



**Note:** Setting the press temperature to above 200C may cause a fire hazard.

## Setting Press Time

Green Set Time Value will flash

Use the up and down arrows to change the value.

Press ok to save the value.

Wait until the current

temperature is the same as the set temperature before using. The press will beep once set temperature is reached. Close and open the press to stop the beeping



# Operating Instructions

## Pressing a T-shirt

- 1.) Turn on the Main Power Switch
- 2.) Set the appropriate Press Temperature, and Time as per your transfer vinyl or sublimation instructions.
- 3.) Place your t-shirt on the heat press.
- 5.) Set the pressure by adjusting the air pressure adjust knob.
- 6.) Wait until current temperature is the same as the set temperature. Once the press has reached set temperature, place transfer material on the shirt. For Sublimation, place the paper with the image face down. For cuttable transfer vinyl, place the matte side with the transparent carrier backing facing the heat platen. If unsure, please refer to the instructions you received with your transfer materials.
- 7.) Slide the heat platen towards the base plate you are pressing. Press the two start switch buttons to close the press. Once press is closed the current time value will start counting down. Once the timer reaches the last 2 seconds before reaching 0, it will start to beep to warn you. Once time reaches zero, the press will open. Slide the heat platen over to press on the next plate.

**Note:** Once the press is closed, it cannot be opened manually until the timer reaches zero. In an emergency, you may press the red emergency stop button to force open the press. When pressing the red emergency stop button, the press will open immediately without warning. Keep hands on the heat press handle at all times during and after pressing the emergency stop button. Not securing the handle with your hands may cause injury.

- 8.) For most sublimation and transfer vinyl, the peel is hot. If unsure, refer to the instructions that came with your transfer materials.

# Heat Press Overview

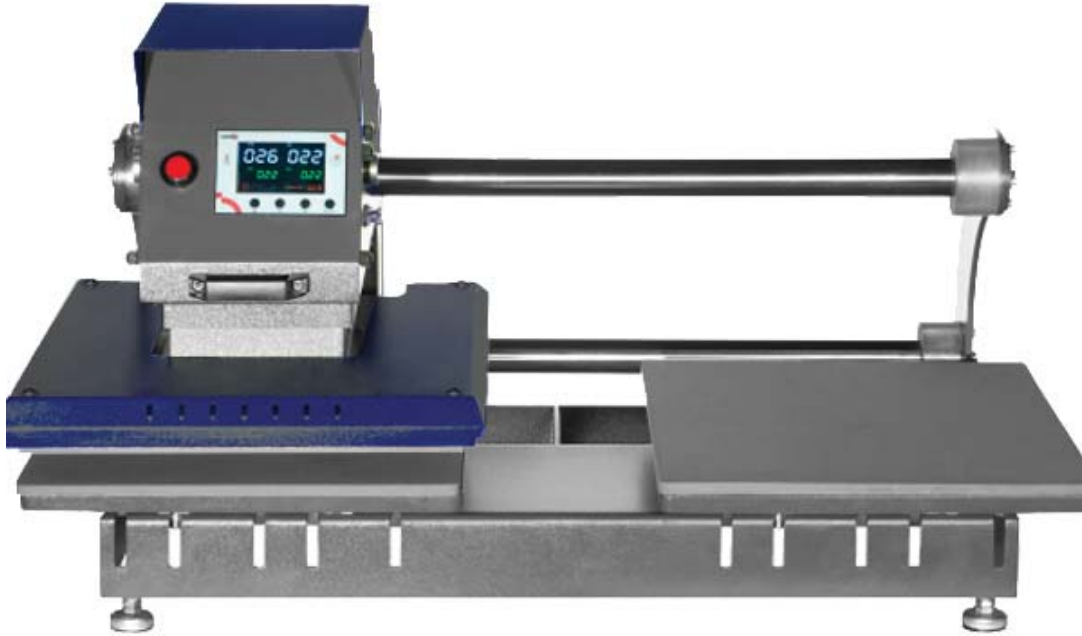

## Technical Specs

Model No.:	E-HP-JSP-1620
Machine Type:	Pneumatic Shuttle Press
Machine Size:	38.2" x 33.86" x 23.60" (97cm x 86cm x 60cm)
Heat Press platen Size:	16" X 20"
Maximum Thickness:	1.20" (30mm)
Controller	GY-06 Digital Controller
Voltage:	120V 14amp
Power:	1200W
Time Range:	0-999 Seconds
Maximum Temp:	491°F (225°C)
Packing Size:	41.34" x 37.4" x 27.56" (105cm x 95cm x 70cm)
Gross Weight:	215lbs (97kg)

Note: This heat press should not be set to exceed 200C. Setting the press temperature to above 200C may cause a fire hazard.

# Maintenance

## General Maintenance

Please switch off the machine and unplug the power cord when the machine is not in use.

To protect the heat platen, do not allow any hard surface objects to be in direct contact with the platen. This includes zippers, buttons, metal sublimation items. When pressing these items, place a protective sheet between the platen and the objects.

The heat-releasing fan will automatically starts when the temperature of heat platen reaches 80 degree C (176 degree F). It helps to reduce the temperature of electrical parts and prolong the service life of them.

Please add the lubrication oil regularly on the joints. To prolong the life of your heat press. The frequency will depend on how often you use your machine.

**Note: This heat press should not be set to exceed 200C. Setting the press temperature to above 200C may cause a fire hazard.**

# Heat Pressing Guide

## MultiCut Ultra Matte

Temperature: 320F  
Time: 20 seconds  
Peel: Hot

## MultiCut Flock Premium

Temperature: 320F  
Time: 20 seconds  
Peel: Hot

## MultiCut Nylon

Temperature: 345F  
1st Press Time: 3 seconds  
2nd Press Time: 10 seconds

## MultiCut Premium

Temperature: 320F  
Time: 10 seconds  
Peel: Hot

## MultiCut Lustre

Temperature: 310-330F  
Time: 15-20 seconds  
Peel: Hot to Cold

## MultiCut Style

Temperature: 310-330F  
Time: 15-20 seconds  
Peel: Hot to Cold



# Heat Pressing Guide (continued)

## Sublimation Items

### Sublimatable Ceramic Tiles

Temperature: 400F  
Time: 360-420 seconds  
Peel: Hot  
Method: Substrate face down  
Image face up

### Porcelain Ornaments

Temperature: 400F  
Time: 180-240 seconds  
Peel: Hot  
Method: Substrate face down  
Image face up

### MousePads/CanCoolers

Temperature: 400F  
Time: 35-45 seconds  
Peel: Hot  
Method: Substrate face up  
Image face down

### Coasters/Fabric Puzzles

Temperature: 400F  
Time: 35-45 seconds  
Peel: Hot  
Method: Substrate face up  
Image face down

### Phone cover inserts

Temperature: 360F  
Time: 120 seconds  
Peel: Hot  
Method: Substrate face down  
Image face up

### Unisub Metals

Temperature: 400F  
Time: 60 seconds  
Peel: Hot  
Method: Substrate face up  
Image face down

### Unisub Plastics

Temperature: 400F  
Time: 75-80 seconds  
Peel: Hot  
Method: Substrate face up  
Image face down

### Unisub Wood

Temperature: 400F  
Time: 75-80 seconds  
Peel: Hot  
Method: Substrate face up  
Image face down

### Unisub Plaques

Temperature: 400F  
Time: 75-80 seconds  
Peel: Hot  
Method: Substrate face up  
Image face down

### WunderBoard Photo Panels

Temperature: 360-375F  
Time: 120-140 seconds  
Peel: Hot  
Method: Substrate face down  
Image face up

# Circuit Diagram

## APDS-15/20 Wire diagram

(GY-06 Digital controller )

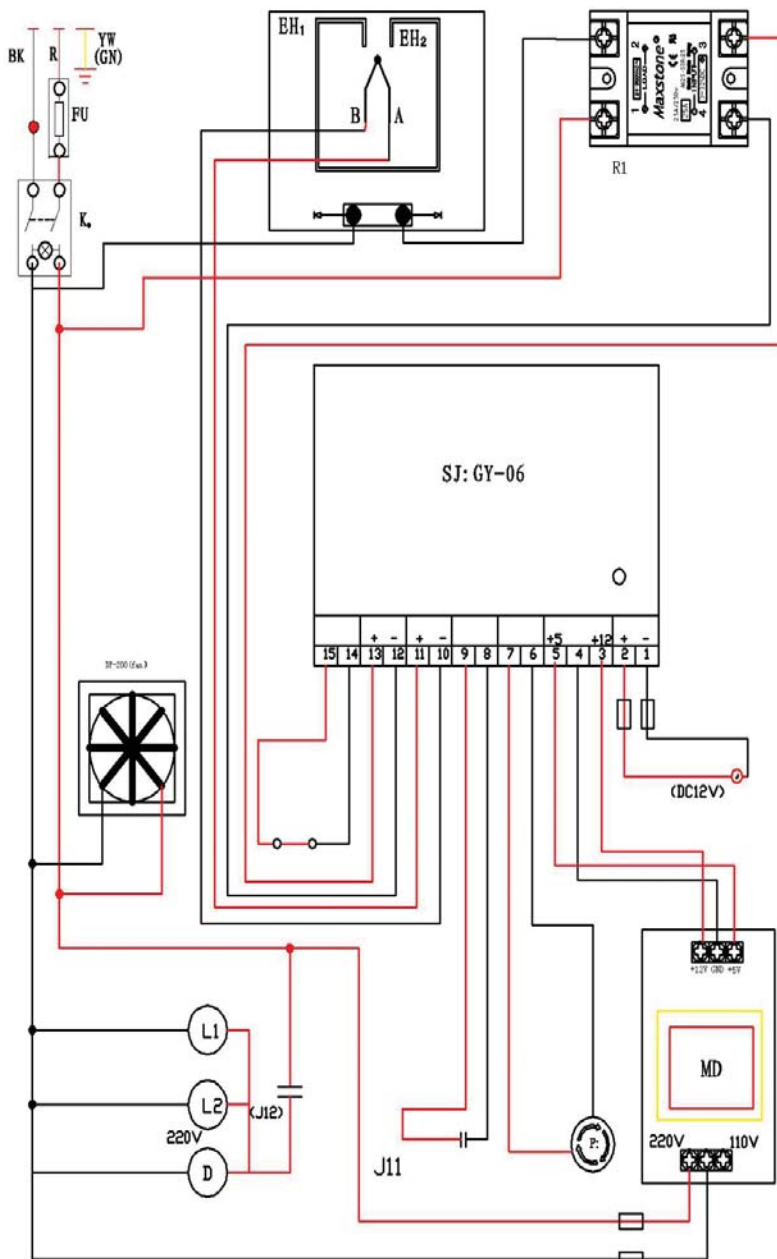

- K0:Power switch
- K1:Start switch
- FU:Fuse
- SJ:GY-06 Digital controller
- HD:Pneumatic controller
- J:Intermediate relay coils
- J11:Intermediate relay contacts 1
- J12:Intermediate relay contacts 2
- L1:Indicator light
- D:Pneumatic electromagnetic valve
- EH1 EH2:Heating pipe
- A-B Thermocouple
- T1/T2:AC/DC Transformer
- P:Emergency stop button

# Expanded Diagram

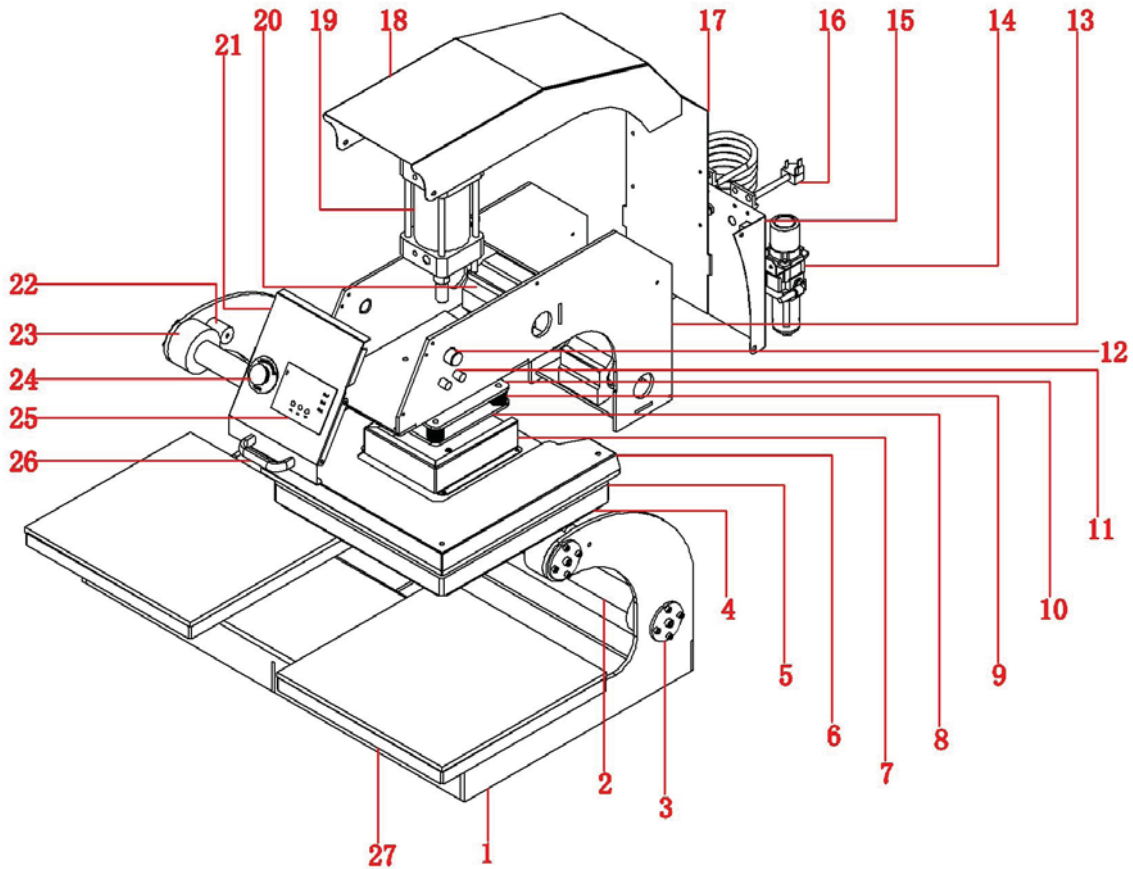

- |                                    |                               |                               |
|------------------------------------|-------------------------------|-------------------------------|
| 1.) Machine Frame                  | 11.) Air Regulating Valve     | 21.) Controller Cover         |
| 2.) Slide Rail                     | 12.) Start Switch             | 22.) Electromagnet            |
| 3.) Slide Rail Fixed Plate         | 13.) Side Plate               | 23.) Casting Polyurethane     |
| 4.) Heat Platen                    | 14.) Air Filter               | 24.) Emergency Stop Button    |
| 5.) Heat Platen Cover              | 15.) Back Plate               | 25.) GY-06 Digital Controller |
| 6.) Anti-Scald Protect Metal Cover | 16.) Power Cord               | 26.) Front Handle             |
| 7.) Spring Protective Cover        | 17.) Electronic Parts Bracket | 27.) Under Plate              |
| 8.) Spring Fixed Cover             | 18.) Upper Cover Plate        |                               |
| 9.) Spring                         | 19.) Air Cylinder             |                               |
| 10.) Side Plate                    | 20.) Spindle with Base        |                               |

**JOTO**<sup>TM</sup>

A red swoosh underline that starts under the 'J' and extends to the right, ending under the 'O'.

**Bringing images to life**<sup>TM</sup>

**[www.jotopaper.com](http://www.jotopaper.com)**

**Tel: 1-800-565-5686**

**Fax: 1-800-565-5622**

**Coquitlam, BC | Mississauga, ON**

**Blaine, WA | Las Vegas, NV | Nashville TN | Akron, OH**